

# WBT-0710 Cu / Ag / Cu mC nextgen™ pole terminal

The perfect loudspeaker terminal for audiophiles

EP Patent 1 470 620

WBT-0710 hybrid construction made of functional materials - nextgen™



### Characteristics:

- Signal conductor made of pure copper or fine silver
- Free from eddy current effects
- No problems with mass storage
- CE and IEC compliant
- RoHS compliant
- Max. constant current 30 A, admissible peak current 200 A
- Surface protection through nickel-free gold plating (Cu) / passivated (Ag)

### nextgen™ – a new generation of connectors made by WBT

The functional requirements for electrical connections as:

1. undistorted and low-loss transmission of signals / current and
2. mechanical stability and electrical security (isolated structure)

are met in an excellent manner by the WBT - nextgen™ principles.

For current / signal transmission pure, soft copper resp. fine silver are used, materials which are excellent not only in electrical conducting, but can also be exactly dosed with the right production process. The metal mass can be reduced by approx. 90%. The disadvantage of the weak mechanical stability of these materials is compensated by highly specialized functional materials. The resulting hybrid construction leads to a significant audible improvement coming from avoiding the big coupling metal masses and an effective reducing of eddy currents.

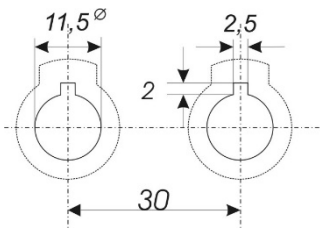

### Mounting

Mounting insulators are included to ensure not only insulated, but also torsion-resistant mounting and polarity identification of the terminals. In case of hi-fi devices being strongly exposed to impact sound such as loudspeakers it is recommended to use an additional nut locking aid which is the fluid screw retention LOCTITE 480<sup>1</sup>. It is matched with WBT high tech plastics, and it is removable. Besides, WBT recommends using the impact sound interrupter WBT-0718.

### Mounting dimensions

- Chassis borehole 11.5 mm Ø, with slot 2.5 x 2 mm for twist protection
- Minimal distance between two terminal's centers: 30 mm
- Outer chassis overhang: 35 mm (max.)

### Component list

- ① Signal conductor
- ② Hexagonal counter nut
- ③ Double step washer
- ④ Covering ring
- ⑤ Base element
- ⑥ Elastomer damper
- ⑦ Pressure nut
- ⑧ Pressure nut cap
- ⑨ Marking ring
- ⑩ Cabinet wall

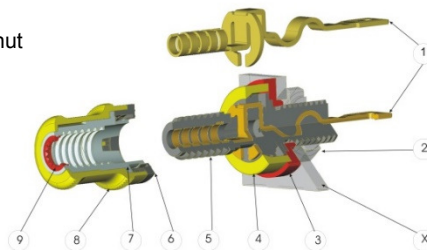

### Termination options:

Outer:	6 mm <sup>2</sup> (10 AWG) wire cross section (max.) 4 mm banana plug Sandwich spades (6 - 8 mm contact fork)
Inner:	Crimping by 6.3 mm flat push-on cable shoe soldering

### Wall thickness:

0.9 – 6.5 mm (in case of wall thickness above 4.5 mm without puzzle plate)

### Color code:

red, white or black

### Hint for equipment manufacturers

Due to the valid safety regulations the 4mm banana holes of WBT pole terminals being used in the field of audio/video within the EU territory have to be closed with the safety stick WBT-0799.

Important information: WBT assumes no liability for incorrect use.

<sup>1</sup>LOCTITE is a brand name of Henkel AG & Co. KGaA.

WBT and nextgen™ are registered trademarks of WBT Germany.

Detailed product information available. Design and specifications subject to change without notice.